

«

»

10  
:(495) 764-26-54, 780-46-71 ICQ 349142703

[www.grand-light.ru](http://www.grand-light.ru)  
[info@grand-light.ru](mailto:info@grand-light.ru)

!!!

KS

KS

- 2 8)



«

»

UNI-I.

KS

1-4-

RAL.

( ): , , , , .

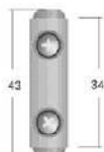
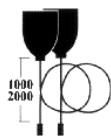
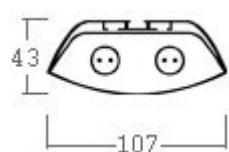

UNI-I

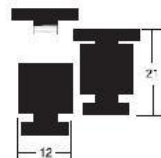

UNI-SU

			( )
KS 218 ( )	1180 107 43	3,30	1052,10
KS 218 ( ),	1180 107 43	3,30	1210,00
KS 218 ( )	1180 107 43	2,60	1428,21
KS 218 ( ),	1180 107 43	2,60	1642,44
KS 218 ( )	1180 107 43	2,60	960,80
KS 218 ( ),	1180 107 43	2,60	1105,00
KS 236 ( )	1750 107 43	4,00	1172,44
KS 236 ( ),	1750 107 43	4,00	1348,31
KS 236 ( )	1750 107 43	3,30	1528,36
KS 236 ( ),	1750 107 43	3,30	1757,61
KS 236 ( )	1750 107 43	3,30	1060,95
KS 236 ( ),	1750 107 43	3,30	1220,09
KS 236 ( ),		3,90	4453,36
KS 258 ( )	2040 107 43	5,00	1589,45
KS 258 ( ),	2040 107 43	5,00	1827,87
KS 258 ( )	2040 107 43	4,00	1696,53
KS 258 ( ),	2040 107 43	4,00	1951,01
KS 258 ( )	2040 107 43	4,00	1414,36
KS 258 ( )	2040 107 43	4,00	1626,51
KS 258 ( ),			4621,53
KS			
BS . / .			19,80
BS			70,00
UNI-SU			93,60
UNI-I			26,50
UNI-Z 1000			129,00
UNI-Z 2000			147,00
UNI-Z 3000			165,00
UNI-Z 4000			183,00

RS



1, 2      3

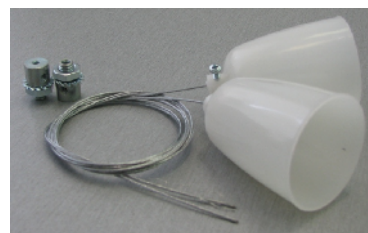
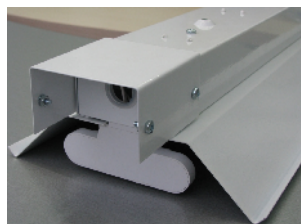

	, ,	, ,	( )
RS 118	620 208 90	2,10	716,56
RS 136	1230 208 90	3,90	876,92
RS 158	1530 208 90	4,95	1247,61
RS 218	620 208 90	2,10	762,72
RS 236	1230 208 90	3,90	1038,45
RS 236 ,	1230 208 90	4,40	4160,18
RS 258	1530 208 90	4,95	1443,29
RS 258 ,	1530 208 90	5,45	4593,29
RS 336			1515,01
RS 358			2058,74
RS			
			80,00
1			171,00
2			189,00
3			207,00
4			225,00

## DR



5 28 54

3

			( )
DR 236	1423 116 71		1180,98
DR 236	1423 116 71		4331,00
DR 258			1413,70
DR 258			4563,66
<b>DR</b>			
BS			19,80
UNI-Z 1000			129,00
UNI-Z 2000			147,00
UNI-Z 3000			165,00
UNI-Z 4000			183,00

## DS



40%

DS-I.

DS-L.

3

DS.

			( )
DS 118	620 100 85	1,30	623,70
DS 136	1226 100 85	2,30	723,80
DS 158	1530 100 85	2,75	955,50
DS 218	620 100 85	1,35	653,10
DS 236	1226 100 85	2,35	840,30
DS 236	1226 100 85	2,85	3990,30
DS 258	1530 100 85	3,00	1133,53
DS 258	1530 100 85	3,50	4283,50
<b>DS</b>			
DS-I			80,00
DS-L			46,00
DS			68,30
1			171,00
2			189,00
3			207,00
4			225,00

## S

(L, , - . ).



1-4-

RAL.

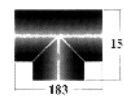
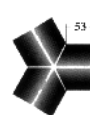
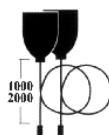
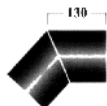
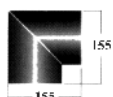
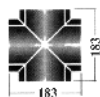

BS 218 ( )	980 127 65	3,30	1094,64
BS 218 ( ),	980 127 65	3,30	1216,51
BS 218 ( )	980 127 65	2,60	1429,67
BS 218 ( ),	980 127 65	2,60	1542,17
BS 218 ( )	980 127 65	2,60	979,67
BS 218 ( ),	980 127 65	2,60	1092,17
BS 236 ( )	1580 127 65	4,00	1409,38
BS 236 ( ),	1580 127 65	4,00	1521,88
BS 236 ( )	1580 127 65	3,40	1734,90
BS 236 ( ),	1580 127 65	3,40	1847,46
BS 236 ( )	1580 127 65	3,40	1350,58
BS 236 ( ),	1580 127 65	3,40	1463,08
BS 236 ( ),	1760 127 65	3,90	4547,46
BS 258 ( )	1960 127 65	5,00	1878,57
BS 258 ( ),	1960 127 65	5,00	2009,82
BS 258 ( )	1960 127 65	4,10	1947,98
BS 258 ( ),	1960 127 65	4,10	2079,23
BS 258 ( )	1960 127 65	4,10	1683,60
BS 258 ( )	1960 127 65	4,10	1814,85
BS-TUB-980	980 127 65	1,70	591,30
BS-TUB-980	980 127 65	1,70	680,40
BS-TUB-1580	1580 127 65	2,80	933,53
BS-TUB-1580	1580 127 65	2,80	1073,25
BS-TUB-1960	1960 127 65	3,40	1182,60
BS-TUB-1960	1960 127 65	3,40	1360,80
<b>BS</b>			
BS . / .			19,80
BS			70,00
BS			63,20
BS .			73,22
BS-L			376,00
BS-L .			415,00
BS-X			720,00
BS-X .			793,00
BS-T			644,00
BS-T .			708,40
BS-135			692,00
BS-135 .			762,00
UNI-SU			93,60
UNI-I			26,50
UNI-Z 1000			129,00
UNI-Z 2000			147,00
UNI-Z 3000			165,00
UNI-Z 4000			183,00

## ZS

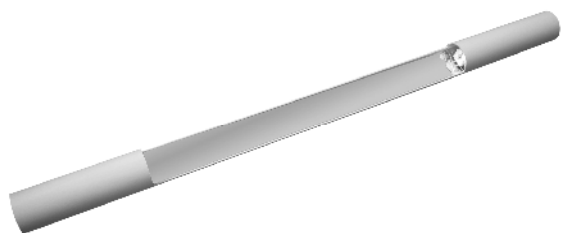

(L, , -

RAL.

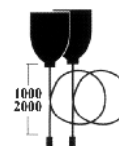
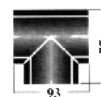
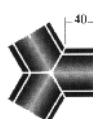
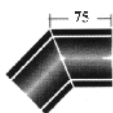
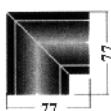
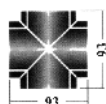

1, 2-

			( )
ZS 118 ( )	1000 60	1,70	662,46
ZS 118 ( ),	1000 60	1,70	699,96
ZS 118 ( )	1000 60	1,55	1153,65
ZS 118 ( ),	1000 60	1,55	1182,55
ZS 118 ( )	1000 60	1,55	703,56
ZS 118 ( ),	1000 60	1,55	732,55
ZS 136 ( )	1600 60	2,10	821,98
ZS 136 ( ),	1600 60	2,10	911,98
ZS 136 ( )	1600 60	1,95	1320,29
ZS 136 ( ),	1600 60	1,95	1401,68
ZS 136 ( )	1600 60	1,95	862,80
ZS 136 ( ),	1600 60	1,95	944,18
ZS 158 ( )	2000 60	3,00	1059,39
ZS 158 ( ),	2000 60	3,00	1171,89
ZS 158 ( )	2000 60	2,85	1443,76
ZS 158 ( ),	2000 60	2,85	1547,65
ZS 158 ( )	2000 60	2,85	1050,02
ZS 158 ( ),	2000 60	2,85	1153,90
ZS-TUB-1000	1000 60	1,10	340,00
ZS-TUB-1000	1000 60	1,10	391,00
ZS-TUB-1600	1600 60	1,76	543,00
ZS-TUB-1600	1600 60	1,76	624,00
ZS-TUB-2000	2000 60	2,20	679,00
ZS-TUB-2000	2000 60	2,20	780,00
<b>ZS</b>			
ZS . / .			19,80
ZS			80,00
ZS			32,80
ZS .			63,18
ZS-L			422,00
ZS-L .			486,00
ZS-X			729,00
ZS-X .			838,00
ZS-T			641,00
ZS-T .			736,00
ZS-120			633,00
ZS-120 .			731,00
UNI-SU			93,60
UNI-I			26,50
UNI-Z 1000			129,00
UNI-Z 2000			147,00
UNI-Z 3000			165,00
UNI-Z 4000			183,00

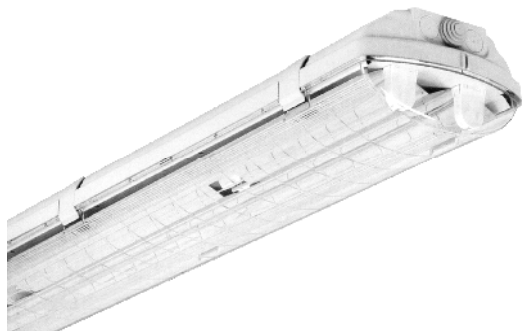
**LEADER IP65**

– IP 65.

: HELVAR, VOSSLON-SCHWABE, BEGHELLI.

			( )
LEADER 218 ( )	670 170 95	2,30	<a href="#">1512,03</a>
LEADER 218 ( )	670 170 95	1,50	<a href="#">1806,36</a>
LEADER 218 ( )	670 170 95	1,50	<a href="#">1342,26</a>
LEADER 236 ( )	1280 170 95	3,30	<a href="#">1729,46</a>
LEADER 236 ( )	1280 170 95	2,40	<a href="#">2028,66</a>
LEADER 236 ( )	1280 170 95	2,40	<a href="#">1564,56</a>
LEADER 258 ( )	1580 170 95	3,80	<a href="#">2276,24</a>
LEADER 258 ( )	1580 170 95	2,90	<a href="#">2323,31</a>
LEADER 258 ( )	1580 170 95	2,90	<a href="#">2058,11</a>

**ELIT**

1 3

ABS,

. IP40.

					( )
Elit-8SE-1N	T5G5	1 8	1	350 137 45	<a href="#">963,60</a>
Elit-8SA-1N	T5G5	1 8	1	350 137 45	<a href="#">1527,99</a>
Elit-8SE-3N	T5G5	1 8	3	350 137 45	<a href="#">1069,60</a>
Elit-8SA-3N	T5G5	1 8	3	350 137 45	<a href="#">1671,52</a>
					<a href="#">148,00</a>